



LMI Plate Joining Jig - PJJN Assembly Instructions

Top Frame

Each frame component (3 arms and 2 sides) (photo1) is marked with an alignment ID (temporary pencil) for assembly

Left side frame front slot pair is 1-1 then 2-2 and 3-3

Right side frame front slot pair is A-A

- ◇ Orient the components to match up the ID's
- ◇ Slip the front frame side slot 1 into arm slot 1 (photo 2)
- ◇ Repeat with middle arm into slot 2 and back arm into slot 3 (photo 3)
- ◇ Slip frame right side into the arm slots starting at A (photo 4)
- ◇ Verify the frame joints are flush and press in the six 1" long binding barrels until flush (photo 5 and insets)
- ◇ Flip the frame over, insert the six 1/2" binding head screws and tighten until snug (photo 6 and insets)

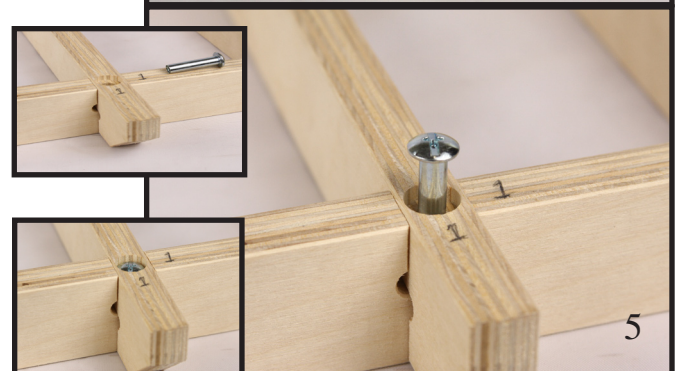
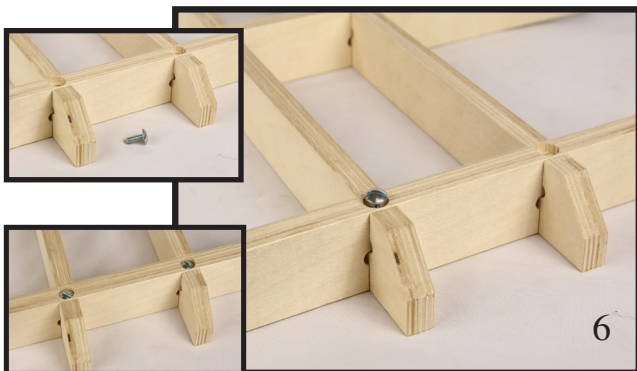
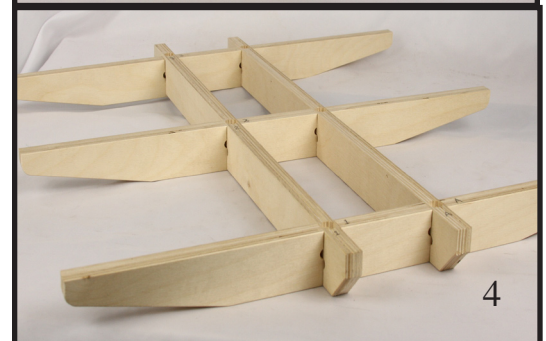
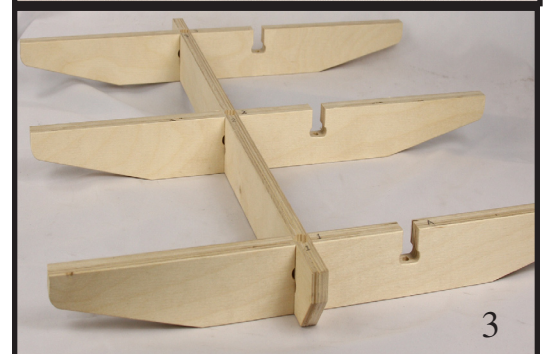
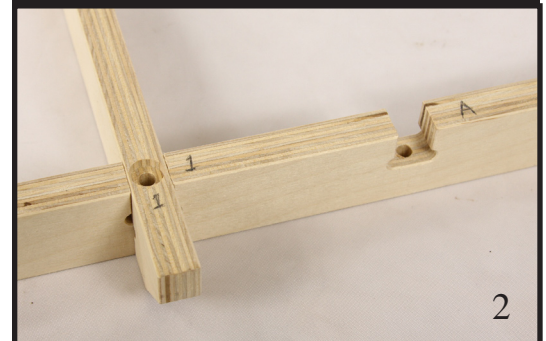
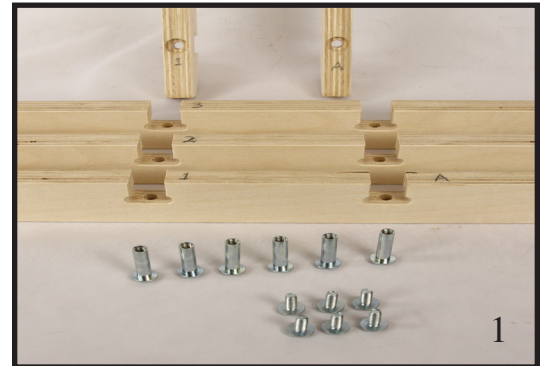

Base

Each base component (3 arms and base plate) (photo 7) is marked with an alignment ID (temporary pencil) for assembly

Left side base front slot pair is 1-1 then 2-2 and 3-3

Right side base front slot pair is A-A

- ◇ Orient the components to match up the ID
- ◇ Slip the front arm slot 1 into base slot 1 (photo 8)
- ◇ Repeat with middle arm into slot 2 and back arm into slot 3 (photo 9)
- ◇ Verify the base joints are flush and press in the six 1 1/2" long binding barrels until flush (photo 10 and insets)
- ◇ Flip the base over, insert the six 1" pan head screws and tighten until snug (photo 10 and insets)
- ◇ Knot the end of each rope and thread it from the inside of the base out

